

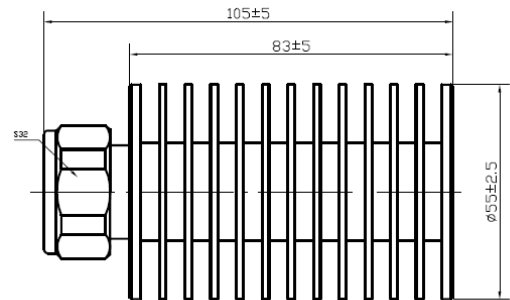

## 7/16 DIN Male 50W Terminator 'Dummy Load'



### 1. Electrical Performance

| Parameter            | Value           |
|----------------------|-----------------|
| Frequency range      | DC to 3GHz      |
| Impedance            | 50±1.5Ω         |
| VSWR                 | ≤1.25           |
| Withstanding Voltage | 2700V           |
| Rated Power          | 50W             |
| Connector Type       | 7/16 (DIN)-Male |
| Standard             | IEC60169-4      |

### 2. Mechanical Performance

| Parameter           | Value          |
|---------------------|----------------|
| Waterproof degree   | IP65           |
| Moisture resistance | IP65           |
| Mating cycles       | ≥500           |
| Outer Dimension     | Φ 105mm × 55mm |

### 3. Environment Performance

| Parameter                   | Value        |
|-----------------------------|--------------|
| Operating temperature range | -40°C~+125°C |
| Storage temperature range   | -30°C~+45°C  |

### 4. Material &Plating

| Connector parts  | Material | Plating |
|------------------|----------|---------|
| Center conductor | Brass    | Silver  |
| Outer conductor  | Brass    | CuSnZn  |
| Dielectric       | PTFE     | /       |
| Radiator         | Aluminum | /       |

### 5. Packing

|          |                                     |
|----------|-------------------------------------|
| Standard | 1 pc/plastic bag in separate carton |
|----------|-------------------------------------|

Remark: Dimensions are in mm with tolerance of ±2%.